

# 5024 # 5170  
# 5504 # 117

## JUDGING PROGRAM

2019146702 2019146704  
2019146705 2019146707

Annual National Specialty Show, Sweepstakes & Veteran Sweepstakes, Futurity,  
Obedience Trial & Rally Trial & Tibetan Terrier Club of America, Inc. Regional Specialty,  
Sweepstakes & Veteran Sweepstakes  
(Unbenched)

# Tibetan Terrier Club of America, Inc.

(Member of the American Kennel Club)



National Specialty Obedience & Rally Trials

**Tues., May 28, 2019**

TRIAL HOURS: 7:00 A.M. TO 10:00 P.M.

National Specialty

**Weds. & Thurs., May 29 & 30, 2019**

Regional Specialty

**Fri., May 31, 2019**

SHOW HOURS: 7:00 A.M. TO 10:00 P.M. - EACH DAY

Boxboro Regency Hotel & Conference Center

242 Adams Place, Boxborough, MA 01719

**JUDGING WILL BE INDOORS**

**AKC NATIONAL OWNER-HANDLED SERIES - AT NATIONAL SPECIALTY**

website: [ttca-online.org](http://ttca-online.org)

---

**Lori Carver, Event Secretary**

c/o MB-F, Inc.

P.O. Box 22107, Greensboro, NC 27420 (336) 379-9352

---

**NATIONAL SPECIALTY - TUESDAY, WEDNESDAY & THURSDAY - MAY 28, 29 & 30, 2019**

**PROGRAM OF JUDGING**

There are 94 dogs entered in this Specialty Show & Trials with a total entry of 135, including 3 obedience entries and 16 rally entries. For your convenience, the following class divisions have been carefully tabulated; however, neither the Club nor the Superintendent/Show Secretary assumes responsibility for absolute accuracy.

<b>TUESDAY - MAY 28, 2019</b>	<b>WEDNESDAY - MAY 29, 2019</b>
<p><b>Obedience/Rally Contact:</b> Jane Goodell (860) 202-9426</p> <p><b>RING ONE</b> <b>JUDGE: Mrs. Lynda S. Moore</b></p> <p><b>10:00 AM</b> Rally Master Class Walk Thru Class to Follow 1 - Rally Master Class Nos 9</p> <p><b>10:15 AM</b> Rally Intermediate Class Walk Thru Class to Follow 5 - Rally Intermediate Class Nos 6 7 12 16 17</p> <p><b>10:40 AM</b> Rally Novice Class A &amp; B/Walk Thru Class to Follow 3 - Rally Novice Class A Nos 18 19 20</p> <p><b>11:00 AM</b> 7 - Rally Novice Class B Nos 6 7 8 10 11 14 15</p> <p><b>RING ONE</b> <b>JUDGE: Mrs. Lynda S. Moore</b></p> <p><b>11:45 AM</b> 2 - Novice Class B Obedience Entries Nos 7 8</p> <p><b>After Noon</b> 1 - Preferred Novice Class Obedience Entries Nos 6</p>	<p><b>RING ONE</b> <b>JUDGE: Ms. Rene' Stamm</b></p> <p><b>10:00 AM</b> Specialty Tibetan Terriers Sweepstakes 2 - Puppy 6 &amp; Und 9 Mo Dogs 4 - Puppy 9 &amp; Und 12 Mo Dogs 2 - Puppy 6 &amp; Und 9 Mo Bitches 1 - Puppy 9 &amp; Und 12 Mo Bitch 4 - Jr 12 &amp; Und 15 Mo Bitches Best in Sweepstakes Best of Opposite Sex to Best in Sweepstakes</p> <p>Specialty Tibetan Terriers Veteran Sweepstakes 2 - 7 &amp; Und 9 Yrs Dogs 1 - 13 Yrs &amp; Over Dog 1 - 7 &amp; Und 9 Yrs Bitch 1 - 9 &amp; Und 11 Yrs Bitch 2 - 11 &amp; Und 13 Yrs Bitches Best in Veteran Sweepstakes Best of Opposite Sex to Best in Veteran Sweepstakes 20 Total Dogs</p> <p><b>RING ONE</b> <b>JUDGE: Ms. Jami Smith</b></p> <p><b>11:15 AM</b> Specialty Tibetan Terriers Futurity 1 - Puppy 12 &amp; Und 15 Mo Bitch Best Futurity Puppy 1 - Jr 18 &amp; Und 24 Mo Dog Best Futurity Junior Grand Futurity Winner 2 Total Dogs</p> <p><b>RING ONE</b></p> <p><b>11:30 AM</b> 18 - Parade of Titleholders</p>

**NOTE:**

To find out about any AKC event cancellations call the AKC Event Cancellation Hotline (877) 252-3229.

**THIS CLUB DOES NOT AGREE TO ARBITRATE CLAIMS AS SET FORTH ON THE OFFICIAL AKC ENTRY FORM FOR THESE EVENTS.**

**PUBLICATION RIGHTS:** By entering this show, all owners, handlers, breeders and kennels agree that all rights to televise, videotape, photograph, advertise, promote and publicize or otherwise exploit this show, or the persons or animals participating in it or the results of the competition before, during or after the event, shall belong solely to The American Kennel Club and their respective assigns, including the use of the names, likenesses or biographical matter of all dogs, owners, handlers, breeders and kennels participating in the show and no such owner, handler, breeder or kennel shall allow any other party to make commercial use of any videotape or photograph of any person or animal participating in this competition.

THURSDAY - MAY 30, 2019

RING TWO

JUDGE: Mr. Mark R. Kennedy

(Judge may take a 45 minute luncheon  
break at his discretion)

10:00 AM

Junior Showmanship Competition

- 1 - Open Intermediate
- 2 - Open Senior
- Best Junior Handler

Specialty

- Tibetan Terriers
- 2 - Puppy 6 & Und 9 Mo Dogs
- 4 - Puppy 9 & Und 12 Mo Dogs
- 1 - B.B.E. Dog
- 2 - Open Dogs
- Winners Dog
- 2 - Puppy 6 & Und 9 Mo Bitches
- 2 - Puppy 9 & Und 12 Mo Bitches
- 4 - 12 & Und 15 Mo Bitches
- 3 - B.B.E. Bitches
- 1 - Am-Bred Bitch
- 2 - Open Bitches
- Winners Bitch
- 4 - Veteran 7 & Und 9 Yrs Dogs
- 1 - Veteran 13 Yrs & Ovr Dog
- 1 - Veteran 7 & Und 9 Yrs Bitch
- 3 - Veteran 11 & Und 13 Yrs Bitches
- 34 - Best of Breed Competition (19-15)
- 1 - Stud Dog
- 3 - Braces

76 Total Dogs

---

JUDGES

Mr. Mark R. Kennedy ..... 4047 Gun Club Rd., Murrysville, PA 15668  
Mrs. Lynda S. Moore ..... 590 New England Rd., Guilford, CT 06437  
Ms. Jami Smith ..... 616 Cutting Way, Sacramento, CA 95831  
Ms. Rene' Stamm ..... 1718 Weider Ct., Quakertown, PA 18951

**\*PROVISIONAL/PERMIT JUDGE - SEE ASSIGNMENTS**

**IMPORTANT** - TRANSFERS of dogs from regular classes to Best of Breed/Variety Competition (Ch. 11 Section 6, AKC Rules) MUST be made to the Superintendent/Show Secretary at least one half hour prior to the start of any regular conformation judging at this show. TRANSFERS by Junior Handlers from Novice to Open Class or from the Open to Master Class MUST be made to the Superintendent/Show Secretary at least one half hour prior to the scheduled start of Junior Showmanship judging at the show. SUBSTITUTIONS of Junior Showmanship dogs must be made at least one half hour prior to the judging of any Junior Showmanship classes at the show. TRANSFERS OF DOGS IN OBEDIENCE/RALLY CLASSES (Ch. 1 Section 16 of Obedience Regulations) The request for transfers must be in writing and presented to the Superintendent/Trial Secretary at least 30 minutes prior to the start of each trial. Transfers for Obedience may be approved, provided the next level class and judge are available and the class has not reached its limit.

---

**Ramps can be used in emergency situations** to judge any breed. In an emergency situation, where use of a ramp is not indicated in the premium list, an exhibitor has the option of withdrawing their entry and receiving a refund. For the judging of juniors the ramp may be used at the discretion of the judge for the ramp optional breeds.

**NOTICE**

*Juniors who win a third Novice Class with competition present, after the closing of entries for a show, **ARE REQUIRED TO TRANSFER** their entry from the Novice Class to the Open Class **BY NOTIFYING** the Superintendent or Show Secretary at least one half hour prior to the scheduled start of Junior Showmanship judging at the show.*

**JUNIORS WITH A DOG ALSO ENTERED IN ANOTHER CLASS OFFERED AT THIS SHOW WHO SUBSTITUTE A DOG NOT ENTERED IN THIS SHOW MUST REMIT THE DIFFERENCE BETWEEN JUNIOR ONLY AND JUNIOR AS AN ADDITIONAL CLASS ENTRY FEE. JUNIORS WHO HAVE ENTERED JUNIOR SHOWMANSHIP ONLY WHO THEN SUBSTITUTE ANOTHER DOG WILL NOT BE CHARGED A FURTHER FEE.**

REGIONAL SPECIALTY, FRIDAY - MAY 31, 2019

PROGRAM OF JUDGING

There are 53 dogs entered in this Specialty Show with a total entry of 69. For your convenience, the following class divisions have been carefully tabulated; however, neither the Club nor the Superintendent/Show Secretary assumes responsibility for absolute accuracy.

RING ONE

JUDGE: Ms. Alessandra R. Folz

RING ONE

JUDGE: Ms. Pamela Bruce

9:00 AM

Specialty

- Tibetan Terriers Sweepstakes
  - 1 - Puppy 6 & Und 9 Mo Dog
  - 3 - Puppy 9 & Und 12 Mo Dogs
  - 1 - Puppy 6 & Und 9 Mo Bitch
  - 2 - Puppy 9 & Und 12 Mo Bitches
  - 2 - Jr 12 & Und 15 Mo Bitches
- Best in Sweepstakes
- Best of Opposite Sex to Best in Sweepstakes

Specialty

- Tibetan Terriers Veteran Sweepstakes
  - 2 - 7 & Und 9 Yrs Dogs
  - 1 - 13 Yrs & Over Dog
  - 1 - 7 & Und 9 Yrs Bitch
  - 1 - 9 & Und 11 Yrs Bitch
- Best in Veteran Sweepstakes
- Best of Opposite Sex to Best in Veteran Sweepstakes

Junior Showmanship Competition

- 1 - Open Intermediate
  - 2 - Open Senior
- Best Junior Handler

17 Total Dogs

10:00 AM

Specialty

- Tibetan Terriers
  - 1 - Puppy 6 & Und 9 Mo Dog
  - 4 - Puppy 9 & Und 12 Mo Dogs
  - 1 - B.B.E. Dog
  - 1 - Open Dog
- Winners Dog
  - 1 - Puppy 6 & Und 9 Mo Bitch
  - 3 - Puppy 9 & Und 12 Mo Bitches
- 12 & Und 15 Mo Bitches
  - 4 - B.B.E. Bitches
  - 1 - Am-Bred Bitch
  - 2 - Open Bitches
- Winners Bitch
  - 2 - Veteran 7 & Und 9 Yrs Dogs
  - 1 - Veteran 7 & Und 9 Yrs Bitch
  - 1 - Veteran 11 & Und 13 Yrs Bitch
- 27 - Best of Breed Competition (16-11)

52 Total Dogs

JUDGES

Ms. Pamela Bruce .....P.O. Box 461 Station Main, Welland On, CN L3B 5R2  
 Ms. Alessandra R. Folz ..... 41 Howard Hill Rd., Foster, RI 02825

**IMPORTANT - TRANSFERS** of dogs from regular classes to Best of Breed/Variety Competition (Ch. 11 Section 6, AKC Rules) MUST be made to the Superintendent/Show Secretary at least one half hour prior to the start of any regular conformation judging at this show. TRANSFERS by Junior Handlers from Novice to Open Class or from the Open to Master Class MUST be made to the Superintendent/Show Secretary at least one half hour prior to the scheduled start of Junior Showmanship judging at the show. SUBSTITUTIONS of Junior Showmanship dogs must be made at least one half hour prior to the judging of any Junior Showmanship classes at the show. TRANSFERS OF DOGS IN OBEDIENCE/RALLY CLASSES (Ch. 1 Section 16 of Obedience Regulations) The request for transfers must be in writing and presented to the Superintendent/Trial Secretary at least 30 minutes prior to the start of each trial. Transfers for Obedience may be approved, provided the next level class and judge are available and the class has not reached its limit.

The show giving club, the event secretary, their agents, employees, etc. assume no responsibility for any loss damage, or injury sustained by exhibitors or handlers to any of their dogs or property, and further assume no responsibility for injury to children.

**The Club and its Superintendent** caution all persons entering the show site and show grounds against all hazards which may exist, including, but not limited to: Condition of the site/grounds, parking/loading/unloading areas, entrances, floors and stairways, elevators and escalators, floor coverings, walkways, tenting/canopies, electrical appliances, cords and fittings, exercise pens, and the presence of animals. All persons should take into consideration this is a sporting event and dress, act and exercise caution appropriate for the activity involved. All persons entering the show, the grounds, site and show areas for whatever purpose do so entirely at their own risk. By virtue of entering the show, the entrant has indicated their acceptance of the terms listed in the premium list and assumes all risks involved.

### Official Photographer

In Focus by Miguel

P.O. Box 28495, Henrico, VA 23228 (804) 396-0730

Book in advance, buy your photos at the show or online at [www.infocusbymiguel.com](http://www.infocusbymiguel.com)

No other photographer or person may take photos of any kind at these events with the purpose of selling the images.  
(Only the Official Photographer may take win pictures.)

### Official Show Videographer

ShowDogVideoPros

June & Irvin Krukenkamp, MD

40 Junction Rd., South Berwick, ME 03908 (207) 200-3837

E-mail: [showdogvideopros@gmail.com](mailto:showdogvideopros@gmail.com) [www.showdogvideopros.com](http://www.showdogvideopros.com)

- This show will be professionally video recorded. No other commercial video recording, video recording from a tripod mounted camera, or any video recording of large segments of the show will be permitted.
- Submission of an entry form and/or physical presence on the show grounds shall constitute both implied and real consent for both the handler and their dog to be video recorded.
- Commercial video recording, video recording from a tripod mounted camera, or any video recording of large segments of the show shall require permission in advance, and in writing, from the club.

### Veterinarian On Call

Westford Veterinary Emergency Referral Center, LLC

11 Cornerstone Sq., Westford, MA 01886 (978) 577-6463

**DIRECTIONS:** Go Northeast on Adams Pl. toward Massachusetts Ave. Turn left onto Massachusetts Ave. Merge onto I-495 N toward Lowell/Lawrence. Take the Boston Rd. Exit, Exit 32, toward Westford. Merge onto Boston Rd. toward MA-225/Nashoba Valley Tech HS. Turn right onto Littleton Rd.. Take first right onto Cornerstone Sq. The Emergency Center is on left. (Distance approximately 10 miles from show site).

**"Exhibitors should follow their veterinarian's recommendation to assure their dogs are free of internal and external parasites, any communicable diseases, and have appropriate vaccinations."**

---

## AKC National Owner-Handled Series

The AKC National Owner-Handled Series is a non-titling competition for dogs that are exhibited by their owners that are not professional handlers. Exhibitors must declare their dog is Owner-Handled eligible at the time of entry on the entry form. Dogs entered in the Amateur-Owner-Handler class will automatically be marked as eligible to compete in the NOHS. Eligible dogs will be identified by an asterisk in the judge's book, steward's book & the catalog. **Dogs must be handled throughout the breed level competition for the regular show by an eligible owner. Professional handlers\*, household members and current assistants\*\* to professional handlers may not exhibit the dog in any NOHS competition during the entire show.** Owner-Handled Best of Breed will be selected from the dogs that are eligible to compete in the Best of Breed competition including Winners Dog, Winners Bitch and winners of the non-regular classes.

- If the Best of Breed/Variety winner is Owner-Handled competition eligible, it will automatically be Owner-Handled Best of Breed/Variety.
- If the Best of Breed/Variety winner is not eligible for Owner-Handled competition and the Best of Opposite Sex to Best of Breed/Variety is eligible, the Best of Opposite Sex to Best of Breed/Variety will compete against the eligible exhibits of the other sex to determine Owner-Handled Best of Breed/Variety.
- If neither the Best of Breed nor the Best of Opposite Sex to Best of Breed/Variety are Owner-Handled competition eligible and Select Dog & Select Bitch are both eligible, the judge is to choose Best Owner-Handled exhibit from the Selects and eligible Winners Dog or Winners Bitch.
- If one of the Selects is eligible, excuse all Champions and non-regular class winners of the same sex and then choose Best Owner-Handled exhibit from the remaining dogs of the opposite sex including the eligible Winners.
- If Best of Breed, Best of Opposite Sex to Best of Breed, Select Dog & Select Bitch are not eligible, the judge may choose any eligible dog remaining in the ring including Winners Dog or Winners Bitch as Owner-Handled Best of Breed/Variety.
- If the Best of Winners is eligible, the other Winner is ineligible since it was defeated.
- No class dogs other than the Winners Dog & Winners Bitch are eligible to return to the ring.

\*Professional handlers are defined as any person who belongs or has belonged to a professional handlers' organization, distributed rate cards, or otherwise advertised or represented themselves as handling dogs for pay within the last five years. \*\*A current assistant is defined as anyone employed by a professional handler on a full-time basis, or assisting a professional handler at the show or any time during the cluster/weekend. Current assistants that are eligible to compete in Junior Showmanship (meet age & amateur status requirements) may participate in NOHS.

## Tentative Schedule of Events

Visit website [tcca-online.org](http://tcca-online.org) for updates. This schedule may be adjusted as time & circumstances require.

<b>Sat. &amp; Sun., May 25th &amp; 26th</b>	<b>All-Breed Agility Trials</b> at LEAP Agility Club, Tolland, CT
<b>Sun., May 26th 8:30 A.M.</b>	<b>TTCA Board Meeting</b>
<b>Sun. &amp; Mon. May 26th &amp; 27th</b>	<b>Jamboree</b> - Companion Dog Activities
<b>Mon., May 27th Morning</b>	<b>TTs Only Agility Trial</b> at American K9 Country, Amherst, NH
	Trial Secretary: Paw Print Trials
	<b>Evening Welcome Event - Opening Celebration</b>
	<b>6:00 - 8:30 P.M. Nosework Seminar</b>
<b>Tues., May 28th 10:00 A.M.</b>	<b>AKC Obedience &amp; Rally Trials</b>
	<b>1:00 - 3:30 P.M. Breeder Education - Judges Study Group</b>
	<b>Evening Top 20 Invitational Evening of Champions</b>
<b>Weds., May 29th Morning</b>	<b>Sweepstakes &amp; Veteran Sweepstakes</b> - Judge: René Stamm
	<b>Parade of Titleholders</b>
	<b>4-6 Month Puppy Competition</b> - Judge: Nanette Prideaux
	<b>Futurity</b> - Judge: Jami Smith
	<b>After Futurity CGC Testing &amp; Trick Dog Evaluation</b>
	<b>Evening 2020 National Fundraising Auction</b> - Hosts: Fran Kridakorn & René Stamm
<b>Thurs., May 30th Morning</b>	<b>National Specialty Conformation with Junior Showmanship</b>
	Judge: Mark R. Kennedy
	<b>Afternoon Celebration with the Winners</b>
	<b>Evening Annual Meeting</b>
<b>Fri., May 31st Morning</b>	<b>TTCA Regional Specialty Conformation</b> - Judge: Pamela Bruce
	<b>Junior Showmanship, Sweepstakes &amp; Veteran Sweepstakes</b>
	Judge: Alessandra R. Folz
<b>Sat., June 1st</b>	<b>Bay Colony Tibetan Terrier Club Regional Specialty</b> at Ladies' Kennel Club, Wrentham, MA Judge: Michael Canalizo



### Tibetan Terrier Club of America, Inc. Canine Good Citizen (CGC) & Trick Dog Testing Wednesday, May 29, 2019

Evaluators: Lauren Fox and Karen Brooks Tromblee

#### Test Entry Form

- |   |  |
|---|--|
| <input type="checkbox"/> Canine Good Citizen (CGC)    | <input type="checkbox"/> Trick Dog Novice (TKN)      |
| <input type="checkbox"/> Trick Dog Advanced (TKA)     | <input type="checkbox"/> AKC Community Canine (CGCA) |
| <input type="checkbox"/> Trick Dog Intermediate (TDI) | <input type="checkbox"/> Trick Dog Performer (TKP)   |
| <input type="checkbox"/> AKC Urban CGC                |  |

Owner/Handler Name: .....

Address .....

City:..... State:..... Zip: .....

Owner (if different):.....

Dog's Call Name..... Date of Birth:.....

Registered Name:.....

Reg. Number ..... AKC PAL ILP:.....

**Mail Entries to: Travis Brock ~ 561 Hickory Hill Rd., Thomaston, CT 06787 (347) 406-4715 E-mail: travbrock@hotmail.com**

Entry Fee: **\$20.00** pre-registration per dog per test    Second Entry (same dog): **\$15.00** pre-registration

Additional Entry (same dog): **\$10.00** pre-registration

Participants Please Note: Props will not be provided (bring your own). Please, no tricks with excessive noise as they might be a distraction to others participating in the show with their dogs.

## NO PRACTICING ALLOWED IN RINGS AT ANY TIME.

**Dogs May Arrive** any time prior to their scheduled time of judging. **Dogs not required for further judging will be excused.**  
**Judges Will Not Wait for Any Dog Holding Up a Class.** Owners or agents alone are responsible for the presence of their dogs in the judging ring when their classes are called to be judged.

**All Dogs Present** must be held on leash or confined to their crates except when being judged or when in the exercising ring.  
**No gasoline or diesel generators** are permitted inside any building or within 100 feet of any tent in which this dog show is conducted.

**As specified in Chapter 12, Section 4** of the AKC Rules Applying to Dog Shows, information contained on the entry form is required to be published in the club's show catalog. This information is also subject to publication in other media.

**Entry Fees** shall not be refunded in the event that a dog is absent, disqualified, excused by Veterinarian or Judge, or barred from competition by action of the event's Show Committee. If because of riots, wars, strikes, civil disturbances, national emergencies, health emergencies, and the dictates of law enforcement or of the owner(s) of the grounds and/or facilities or other acts beyond the control of the management it is impossible to open or to complete the show, no refund of entry fee will be made. Extreme weather conditions, such as, but not limited to, snow storms, hurricanes, lightning, extreme heat, heavy rains, or other circumstances including, but not limited to, the condition of the facilities or grounds and/or the ingress and egress from the grounds, must be considered for the health and safety of the dogs, exhibitors and spectators. The well-being of dogs, exhibitors and spectators is of paramount importance and, in the event it is necessary to cancel or stop the show before completion, no refund of entry fee will be made.

## Hotel Reservations

**Boxboro Regency Hotel & Conference Center** - 242 Adams Place, Boxborough, MA 01719  
Reservations: (978) 263-8701 www.boxbororegency.com

**DIRECTIONS:** Exit #28 off Rt. I-495. Coming from the North, cross over 495 and the hotel will be on your right; from the South, the hotel will be just beyond the exit on your right.

**BOOK EARLY AN BE SURE TO MENTION THE TTCA.**

**RV PARKING:** Contact the Hotel - \$30.00 per day.

**HOTEL PET POLICY:** There is a \$50.00 non-refundable cleaning fee to house a pet in a room. Four (4) dogs maximum per room.

**A valid credit card is required at check-in** to be used for a damage deposit. Guests paying cash must pay an additional \$100.00 damage deposit per owner. Boxboro Regency Hotel reserves the right to charge a guest for excessive damages by the pet in the room (i.e. chewed or scratched furniture, stained rugs, chairs or linens, etc.).

**Due to an environmentally sensitive area** along the back of the hotel, no dogs are permitted in that area. See diagram below. Exercise area, ex-pens and bathroom areas are also indicated.

**Unattended dogs in sleeping rooms MUST be crated.** Plastic is required under crates and will be provided.

**No bathing of dogs in guest rooms.** If there is evidence that pets have been bathed in the guest rooms or public bathroom, you will forfeit your deposit.

**Exercise your dogs only in designated exercise areas,** where ex-pens and cleanup supplies will be provided. As per town law, all dogs must be on leash when outside and on public property. Exhibitors are responsible for picking up after their dogs on the grounds and for keeping their crating area in Exhibit Hall clean. If your dog should urinate or defecate anywhere inside the hotel, you are responsible for cleanup. Carry a plastic bag with you at all times.

**The hotel housekeeping staff MUST be given daily access to every room.**

**Pets are not allowed in any food establishment** in the hotel or any place there is food being served (aside from room service and scheduled events).

**We expect everyone to be polite to hotel staff and management.** The Show Committee will be in daily contact with the housekeeping staff to monitor situations that require intervention. Participants who do not comply with hotel rules will be required to vacate the premises immediately.

**No ex-pens allowed in crating/grooming room.** Ex-pens only allowed in designated areas.

**The Show Committee reserves the right** to remove any areas roped off by exhibitors and to allocate or designate crate & grooming space.

**Please respect all hotel properties.** Any exhibitors who leave their rooms in disrepair will be subject to disciplinary action. Upon determination

that a violation has occurred, an Event Committee hearing will follow. If found guilty, monetary restitution must be made to the Hotel. The violator(s) will be asked to leave the grounds and face possible fines and/or AKC suspension.

**The TTCA requires dogs to be crated when unattended** in the National Specialty hotel rooms and the rooms to be left in the same condition as when first occupied. Failure to abide by these rules will result in those individual's names being given to future hotels with the intent of being refused occupancy. As the Host Hotel is also the show grounds, you can be brought up before an AKC Event Committee for not complying with the rule to leave your hotel room in proper condition.

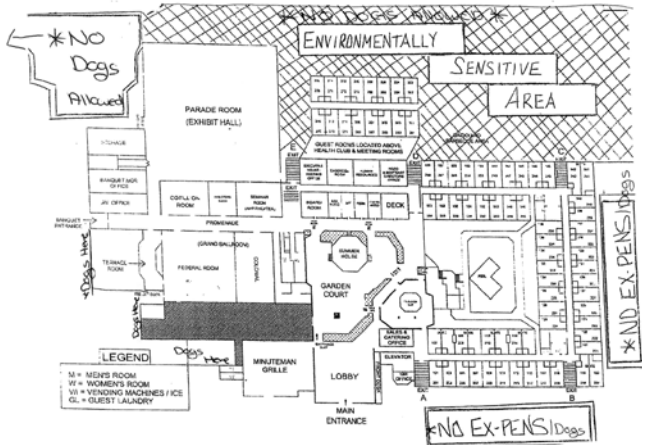

# AKC Code of Sportsmanship

*PREFACE: The sport of purebred dog competitive events dates prior to 1884, the year of AKC's birth. Shared values of those involved in the sport include principles of sportsmanship. They are practiced in all sectors of our sport: conformation, performance and companion. Many believe that these principles of sportsmanship are the prime reason why our sport has thrived for over one hundred years. With the belief that it is useful to periodically articulate the fundamentals of our sport, this code is presented.*

- Sportsmen respect the history, traditions and integrity of the sport of purebred dogs.
- Sportsmen commit themselves to values of fair play, honesty, courtesy, and vigorous competition, as well as winning and losing with grace.
- Sportsmen refuse to compromise their commitment and obligation to the sport of purebred dogs by injecting personal advantage or consideration into their decisions or behavior.
- The sportsman judge judges only on the merits of the dogs and considers no other factors.
- The sportsman judge or exhibitor accepts constructive criticism.
- The sportsman exhibitor declines to enter or exhibit under a judge where it might reasonably appear that the judge's placements could be based on something other than the merits of the dogs.
- The sportsman exhibitor refuses to compromise the impartiality of a judge.
- The sportsman respects the AKC bylaws, rules, regulations and policies governing the sport of purebred dogs.
- Sportsmen find that vigorous competition and civility are not inconsistent and are able to appreciate the merit of their competition and the effort of competitors.
- Sportsmen welcome, encourage and support newcomers to the sport.
- Sportsmen will deal fairly with all those who trade with them.
- Sportsmen are willing to share honest and open appraisals of both the strengths and weaknesses of their breeding stock.
- Sportsmen spurn any opportunity to take personal advantage of positions offered or bestowed upon them.
- Sportsmen always consider as paramount the welfare of their dog.
- Sportsmen refuse to embarrass the sport, the American Kennel Club, or themselves while taking part in the sport.



**AMERICAN  
KENNEL CLUB®**